



THE VISION

Lofa Liberia New City 2027 is a next-generation integrated development combining clean energy, advanced agriculture, digital infrastructure, modern living, and sustainable industries to create jobs, reduce poverty, and build a stronger nation.

KEY HIGHLIGHTS

- 100% GREEN POWER**
Hydrogen + Hydro
- SMART & SUSTAINABLE CITY**
Green Buildings, Clean Water, Waste Management
- FOOD SECURITY**
Year-Round Production
- EDUCATION & HEALTH**
Human Capital Development
- DIGITAL INFRASTRUCTURE**
Data Center & Connectivity
- INDUSTRY & INNOVATION**
Jobs, Technology & Economic Growth
- COLD STORAGE & FOOD BANK**
Community & National Food Support
- SAFE, SECURE & RESILIENT**
Built to Withstand Natural Disasters

PHASED DEVELOPMENT

PHASE 1	PHASE 2	PHASE 3
2024 - 2026	2027 - 2029	2030+
Foundation Infrastructure Power & Water Pilot Greenhouses Data Center	Expansion Residential Areas Industrial Park Additional Greenhouses Commercial Hub	Growth & Scale More Communities Export & Trade Regional Leadership

MASTER PLAN OVERVIEW

- Residential
- Commercial
- Industrial
- Agriculture
- Utilities & Energy
- Public & Institutional
- Recreation & Green Space



INTEGRATED GREEN INFRASTRUCTURE

- Hydrogen Energy Production
- Vertical Farming & Controlled Agriculture
- Water Treatment & Management
- Waste-to-Energy & Recycling
- Smart Grid & Energy Storage
- High-Speed Data & Communications



PROJECT IMPACT

- 10,000+ Jobs Direct & Indirect
- Food Security For the Nation
- Clean Energy 24/7, Zero Emission
- Stronger Economy Local & Regional Growth
- Better Living For All Citizens
- Resilient Future For Generations

LOCATION



Lofa County, Liberia

LOFA LIBERIA NEW CITY 2027
BUILDING TODAY.
EMPOWERING TOMORROW.
LEADING AFRICA.

LOFA SURGERY CENTER & CENTRE

250-BED MULTISPECIALTY HOSPITAL & SURGERY CENTER

Compassionate Care. Advanced Medicine. Better Outcomes.



OUR SERVICES

Genet Surgery	Cardiology	Orthopedics	Neurosurgery	Pediatrics
Obstetrics & Gynecology	ENT	Ophthalmology	Urology	Internal Medicine
Oncology	Dental Care	Plastic Surgery	Anesthesiology	Radiology

STATE-OF-THE-ART FACILITIES

- 10 Modern Operating Theatres
- Fully Digital Imaging (CT, MRI, X-Ray, Ultrasound)
- Advanced ICU & Critical Care Units
- Laminar Flow OT & Infection Control Systems
- Electronic Medical Records (EMR)
- Robotic & Minimally Invasive Surgery
- 24/7 Power, Water & Oxygen Supply
- High-Speed Internet & Telemedicine



HOSPITAL HIGHLIGHTS

- 250 Beds Capacity
- Advanced Surgery Center
- 24/7 Emergency & Trauma Care
- Fully Equipped ICU, NICU, PICU
- Advanced Diagnostic Imaging
- Modern Labor & Delivery Suites
- Pharmacy & 24/7 Laboratory
- Rehabilitation & Physiotherapy
- Rooftop Helipad
- Solar Power & Energy Backup
- Smart Hospital Management System
- Patient-Centered Care

KEY FEATURES

- Modern Infrastructure
- 24/7 Security & CCTV
- Reliable Power & Backup
- Water Supply & Drainage
- High-Speed Internet
- Sustainable Environment
- Wide Roads & Easy Access
- Skilled Workforce & Support
- One-Stop Patient Care



ADVANCED MEDICAL EQUIPMENT

High-End MRI & CT Scanners	Digital X-Ray & Ultrasound	Advanced Patient Monitors	Modern Ventilators	Robotic Surgery System	Laboratory Analyzers
----------------------------	----------------------------	---------------------------	--------------------	------------------------	----------------------

NEW PROJECT
NEW CITY
LOFA WEST AFRICA

DEVELOPMENT
IN ON THE RIVER
Condo

3 STORY | 3 BEDROOM

Experience modern living along the beautiful riverfront in the heart of New City Lofa West Africa. In On The River Condo offers the perfect blend of luxury, comfort, and convenience.

- RIVERFRONT LIVING
- SECURE COMMUNITY
- MODERN DESIGN
- SUSTAINABLE LIVING



IN ON THE RIVER
CONDO

MODERN LIVING. RIVERFRONT SERENITY.

In On The River Condo is a premium 3-story, 3-bedroom residence designed for families, professionals, and investors seeking a high-quality lifestyle in one of West Africa's fastest-growing new cities.

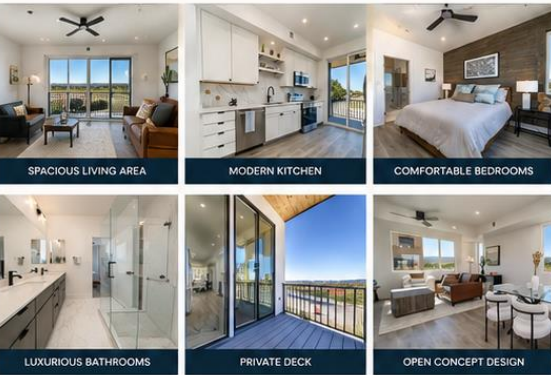

- RESIDENCE FEATURES**
- 3 Spacious Bedrooms
 - 2.5 Modern Bathrooms
 - Open Concept Living & Dining
 - Private Balcony/Deck
 - 1-Car Garage
 - High-End Finishes Throughout

New City Lofa, West Africa, the In On The River Condo development is a modern three-story residential community designed to combine luxury living with comfort, security, and natural beauty. The project features contemporary architecture, open-concept interiors, private balconies, spacious living areas, modern kitchens, and high-end finishes throughout. The gated community is designed for families, professionals, and investors seeking a premium waterfront lifestyle with access to modern amenities, sustainable living features, and scenic river views. With stylish townhome layouts, secure surroundings, and close proximity to schools, shopping, and services, the development offers a modern urban living experience in one of West Africa's growing new city projects.

IN ON THE RIVER
CONDO

NEW CITY LOFA
WEST AFRICA

DEVELOPMENT PLAN
120 UNITS

3 STORY | 3 BEDROOM

A master-planned riverfront community offering modern condo living in a secure, sustainable, and beautifully designed environment.

- LEGEND**
- 3 STORY CONDO BUILDING (3 BEDROOM UNITS)
 - CLUBHOUSE & AMENITIES
 - PARK & GREEN SPACE
 - PARKING AREAS
 - ROADS & DRIVEWAYS
 - RIVERFRONT WALKWAY
 - ENTRY / SECURITY GATE

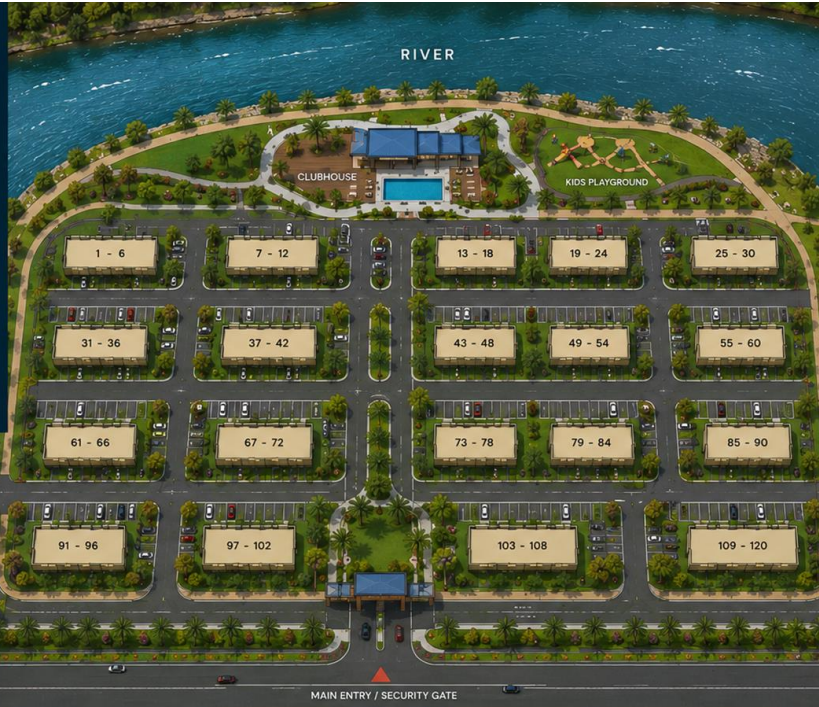

UNIT BREAKDOWN

UNIT TYPE	NO. OF UNITS
3 BEDROOM CONDO (3 STORY)	120 UNITS
TOTAL UNITS	120 UNITS

- DEVELOPMENT FEATURES**
- 120 Spacious 3-Bedroom Condo Units
 - 3-Story Modern Buildings
 - Clubhouse with Pool & Lounge
 - Kids Playground by the River
 - Ample Parking for Residents & Guests
 - 24/7 Security & Controlled Access
 - Landscaped Parks & Green Spaces
 - Roof-top Terraces on Each Building
 - Riverfront Walkway & Scenic Views
 - Sustainable & Energy-Efficient Design

- AMENITIES**
- Riverside Clubhouse & Pool
 - Kids Playground
 - Fitness Center
 - Community Lounge
 - Walking & Jogging Trails
 - Beautiful Riverfront Promenade
 - Green Parks & Sitting Areas



- PROJECT HIGHLIGHTS**
- Prime Riverfront Location
 - Gated & Secure Community
 - High Quality Construction
 - Modern Architecture & Design
 - Close to Schools, Shops & Services
 - Strong Investment Opportunity



NEW CITY LOFA
WEST AFRICA

A visionary new city project bringing modern infrastructure, world-class amenities, and sustainable development to West Africa.

LIVE. INVEST. THRIVE.

CONTACT US

+231 77 123 4567

info@newcitylofa.com

www.newcitylofa.com

New City Lofa, West Africa



LIVE. INVEST. THRIVE.

New City Lofa West Africa is a visionary riverfront community designed for modern living and long-term value.

A place to live beautifully. A place to invest wisely. A place to thrive.



IN ON THE RIVER CONDO
WHERE MODERN LIVING MEETS NATURAL BEAUTY.



MOUNTAIN DEV
HOUSING DEVELOPMENT

Live in Nature. Build Your Future.

LOOFAH COUNTY,
LIBERIA – WEST AFRICA

**2-BEDROOM
MODERN FARMHOUSE**
COMFORT. QUALITY. COMMUNITY.

Mountain Dev offers beautifully designed, affordable homes in a peaceful, secure, and well-planned community—perfect for families, professionals, and investors.

- 2 BEDROOMS
- 1 BATHROOM
- OPEN CONCEPT LIVING & KITCHEN
- STORAGE SPACE
- FRONT PATIO

FLOOR PLAN
34' X 24' – OPEN CONCEPT LAYOUT



HOME FEATURES

- 2 Spacious Bedrooms
- 1 Full Bathroom
- Open Concept Living Room and Kitchen
- Convenient Storage Space
- Front Patio – Perfect for Relaxing & Entertaining
- Quality Materials & Modern Finishes
- Ideal for Families, Professionals & Retirees

UNIT DETAILS

- HOME SIZE: 34' X 24'
- TOTAL LIVING SPACE: 816 SQ FT
- FRONT PATIO: 204 SQ FT
- TOTAL UNDER ROOF: 1,020 SQ FT

BUILT FOR YOUR FUTURE
Enjoy the perfect blend of natural beauty and modern living in a growing community with great potential and lasting value.

COMMUNITY BENEFITS

- Peaceful & Secure Environment
- Well-Planned Infrastructure
- Access to Schools, Markets & Essential Services

INVEST IN TOMORROW
With approximately 120 units per subdivision, Mountain Dev is your opportunity to own a home and be part of a thriving development in Liberia.

CONTACT US | Be Part of a Better Tomorrow. | MOUNTAIN DEV – More Than a Home, It's a Lifestyle.

Mountain Dev Housing Development is a modern residential community designed to provide affordable, comfortable, and secure living in a peaceful natural setting. The development features stylish two-bedroom modern farmhouse homes with open-concept living areas, front patios, storage space, and quality modern finishes. Designed for families, professionals, retirees, and investors, the community offers well-planned infrastructure, access to essential services, and a safe neighborhood environment. With approximately 120 homes planned per subdivision, Mountain Dev combines modern living, community-focused design, and long-term investment potential in one of West Africa's growing development regions.



MOUNTAIN DEV
HOUSING DEVELOPMENT

Live in Nature. Build Your Future.

LOOFAH COUNTY,
LIBERIA – WEST AFRICA

120 BEAUTIFULLY DESIGNED HOMES
2-BEDROOM | 1 BATHROOM
OPEN CONCEPT LIVING & KITCHEN
STORAGE | FRONT PATIO

2-BEDROOM MODERN FARMHOUSE
COMFORT. QUALITY. COMMUNITY.

120 UNITS



FLOOR PLAN
34' X 24' – OPEN CONCEPT LAYOUT



UNIT DETAILS

- HOME SIZE: 34' X 24'
- TOTAL LIVING SPACE: 816 SQ FT
- FRONT PATIO: 204 SQ FT
- TOTAL UNDER ROOF: 1,020 SQ FT

BUILT FOR YOUR FUTURE
Enjoy the perfect blend of natural beauty and modern living in a growing community with great potential and lasting value.

COMMUNITY BENEFITS

- Peaceful & Secure Environment
- Well-Planned Infrastructure
- Access to Schools, Markets & Essential Services

INVEST IN TOMORROW
With approximately 120 units per subdivision, Mountain Dev is your opportunity to own a home and be part of a thriving development in Liberia.

TWO MAIN ENTRANCES | PLANNED STREETS | SIDEWALKS THROUGHOUT | CENTRAL PARK | ADDITIONAL GREEN SPACES | MOUNTAIN DEV – More Than a Home, It's a Lifestyle.

MODERN OUTDOOR LIVING

LIVE OUTSIDE. LIVE BETTER.



FEATURES

-  Open plan living with seamless indoor-outdoor flow
-  Kitchen open to living and dining
-  1 Shared Bathroom
-  1 Bedroom (Option A) or 2 Bedrooms (Option B)

SPECIFICATIONS

- Total Living Area: 72.5 m² (780 sq ft)
- Covered Patio: 18.0 m² (194 sq ft)
- Total Area: 90.5 m² (974 sq ft)
- Dimensions: 10.5m x 8.6m

IDEAL FOR

-  Small Families
-  Couples
-  Holiday Home or Rental

DIMENSIONS

- Width: 10.5m
- Depth: 8.6m
- Ceiling Height: 2.7m

KEY

-  Door
-  Window

FLOOR PLAN – OPTION A (1 BEDROOM)



FLOOR PLAN – OPTION B (2 BEDROOMS)



Modern Outdoor Living

home concept combines open-plan design with seamless indoor-outdoor flow. The residence features large sliding glass doors, a modern kitchen connected to the living and dining areas, covered outdoor patio space, and rooftop solar panels for energy-efficient living. The layout offers flexible one-bedroom or two-bedroom floor plan options, making it ideal for small families, couples, vacation homes, or rental properties. With modern finishes, natural ventilation, and functional outdoor spaces, the design focuses on comfort, simplicity, and modern lifestyle living.



SUSTAINABLE DESIGN



ENERGY EFFICIENT



NATURAL VENTILATION



QUALITY MATERIALS



BUILT FOR DURABILITY



COMFORT & FUNCTIONALITY



ACADEMY FOR THE UP-AND-COMING SOCCER AFRICA

DEVELOPING TALENT. BUILDING FUTURES.

WORLD-CLASS FACILITIES. HOMEGROWN CHAMPIONS.



6 TRAINING FIELDS



1 STADIUM (2,000 SEATS)



160 RESIDENTS CAPACITY



FULL AMENITIES



HOLISTIC DEVELOPMENT



MAIN STADIUM - 2,000 SEATS



RESIDENTIAL LIVING



BOYS' DORMITORY



GIRLS' DORMITORY

AMENITIES



DINING HALL



CLASSROOM



FITNESS CENTER



MEDICAL CENTER



RECREATION LOUNGE



LAUNDRY ROOM

ACADEMY VALUES



DISCIPLINE



RESPECT



TEAMWORK



INTEGRITY



EXCELLENCE

"We don't just build players, we build leaders."

- 24/7 SECURITY
- MEDICAL CENTER
- FITNESS CENTER
- CLASSROOMS
- LAUNDRY SERVICES
- PRACTICE AREAS
- CHAPEL / MEDITATION
- PARKING

CAMPUS OVERVIEW

Academy for the Up-and-Coming Soccer Africa is a premier residential soccer academy designed to develop the next generation of African football stars. Our world-class facilities, expert coaching, and holistic approach ensure athletes grow on and off the field.

KEY HIGHLIGHTS

- 6 Full-sized Training Fields
- 1 Main Stadium (2,000 Capacity)
- Residential Living for 160 Young Athletes
- Separate Boys' and Girls' Dormitories
- Nutritious Meals, Education, and Life Skills
- Top-tier Coaching and Sports Science

CAMPUS LOCATION

Strategically located in Africa to provide world-class training in a safe, inspiring, and accessible environment.

Building Africa's Future,
One Player at a Time.



Next generation of African football talent, the Academy for the Up-and-Coming Soccer Africa is a modern residential sports training campus focused on athletic development, education, discipline, and leadership. The academy features six full-sized training fields, a 2,000-seat stadium, classrooms, fitness centers, medical facilities, study and recreation areas, and separate residential housing for boys and girls.

The campus combines professional coaching, sports science, education, and life-skills training in a secure and supportive environment designed to help young athletes grow both on and off the field while preparing them for future careers in sports and leadership.

The campus combines professional coaching, sports science, education, and life-skills training in a secure and supportive environment designed to help young athletes grow both on and off the field while preparing them for future careers in sports and leadership.



ACADEMIC SCHOOLS & PROGRAMS

FARMING & AGRICULTURE <ul style="list-style-type: none"> • Agronomy • Animal Science • Soil & Water Management • Agricultural Economics 	MINING (GOLD & DIAMONDS) <ul style="list-style-type: none"> • Mining Engineering • Geology • Mineral Processing • Safety & Environment
HEAVY EQUIPMENT TRAINING <ul style="list-style-type: none"> • Equipment Operation • Maintenance • Safety Certification • Workshops & Simulators 	HEALTH SCIENCES & NURSING <ul style="list-style-type: none"> • Nursing (RN) • Midwifery • Public Health • Allied Health
MEDICAL PROFESSIONS <ul style="list-style-type: none"> • Medicine • Pharmacy • Laboratory Science • Surgery Assistant 	RADIATION SCIENCES & RADIOLOGY <ul style="list-style-type: none"> • Radiography • Radiation Therapy • Nuclear Medicine • Radiology (MRI, CT, X-Ray)
PROFESSIONAL & SUPPORT SERVICES <ul style="list-style-type: none"> • Business Administration • ICT & Data Management • Human Resources • Hospitality & Tourism 	

STUDENT HOUSING

- 75% of total students housed
- Separate male & female dorms
- Modern rooms with internet
- Study lounges & recreation areas
- 24/7 Security

CAMPUS AMENITIES

<ul style="list-style-type: none"> • Multiple Cafeterias • Auditorium (1,000 Seats) • Bookstore & Shops • Banks & ATM • Post Office 	<ul style="list-style-type: none"> • Wi-Fi Campus Wide • Gym & Fitness Center • Sports Fields & Courts • Multipurpose Hall • Transport Services
--	--

University of Lofa is designed as a modern higher education campus that prepares students for careers in agriculture, mining, healthcare, engineering, heavy equipment operations, radiation sciences, and professional services. The university combines advanced academic programs with practical training facilities, modern laboratories, medical training centers, student housing, sports facilities, and sustainable campus infrastructure.

The campus is built to support hands-on learning, research, entrepreneurship, and community development while helping train future leaders and skilled professionals for Liberia and Africa's growing industries.

ABOUT UNIVERSITY OF LOFA

University of Lofa is a premier institution dedicated to excellence in education, practical training, research, and community development. We prepare students to lead and transform industries in farming, mining, healthcare, and beyond.

KEY FEATURES

- ✓ Classrooms for up to 3,000 Students
- ✓ World-Class Laboratories & Workshops
- ✓ Industry Partnerships & Internships
- ✓ Modern Medical Training Hospital
- ✓ Safe, Green, and Sustainable Campus
- ✓ Innovation, Research & Entrepreneurship Hub

AT A GLANCE

<p>3,000 STUDENTS CAPACITY</p>	<p>75% STUDENTS HOUSING</p>	<p>6+ FACULTIES & SCHOOLS</p>	<p>50+ BUILDINGS & FACILITIES</p>	<p>1000+ STAFF & LECTURERS</p>
---	--	--	--	---



LOFA PRACTICAL COLLEGE

LEARN. PRACTICE. BUILD. SUCCEED.

Real Skills. Real Training. Real Jobs.

PRACTICAL SKILLS. REAL OPPORTUNITIES. BRIGHT FUTURES.

- HANDS-ON TRAINING
- MODERN EQUIPMENT
- INDUSTRY EXPERTS
- JOB READY GRADUATES
- ENTREPRENEUR SUPPORT

**BUILDING SKILLS.
BUILDING COMMUNITIES.
BUILDING AFRICA.**



OUR TRAINING PROGRAMS

AUTOMOTIVE & MECHANICAL <ul style="list-style-type: none"> • Car Mechanics • Auto Electrical • Diesel Mechanics 	BUILDING & CONSTRUCTION <ul style="list-style-type: none"> • Building Construction • Road Construction • Masonry & Concrete • Roofing • Plastering & Tiling
PLUMBING & ELECTRICAL <ul style="list-style-type: none"> • Plumbing • Electrical Installation • Solar & Renewable Systems 	WOODWORK & FABRICATION <ul style="list-style-type: none"> • Carpentry • Cabinet Making • Joinery • Fence Building • Welding & Fabrication
MINING & HEAVY EQUIPMENT <ul style="list-style-type: none"> • Mining Operations • Drilling & Blasting • Mineral Processing • Gold, Diamond & Bauxite Training • Heavy Equipment Operation 	ELECTRICAL SYSTEMS – MINING <ul style="list-style-type: none"> • Electrical Systems • Mine Power Systems • Instrumentation • Automation • Maintenance & Troubleshooting
BUSINESS & ENTREPRENEURSHIP <ul style="list-style-type: none"> • Basic Business Skills • Company Structure • Setting Up a Business • Bank Accounts • Bookkeeping • Financial Management 	

WE TRAIN. YOU PRACTICE. YOU BUILD THE FUTURE.

- DISCIPLINE
- SAFETY
- INTEGRITY
- TEAMWORK
- EXCELLENCE

FACILITIES & AMENITIES

- Modern Classrooms
- Workshops & Labs
- Heavy Equipment Yard
- Library & Resource Center
- Computer Lab
- Student Dormitories
- Cafeteria
- Sports & Recreation
- Health Center
- 24/7 Security

EQUIPMENT & MACHINERY TRAINED ON

- Excavators
- Bulldozers
- Loaders
- Graders
- Dump Trucks
- Backhoes
- Forklifts
- Rollers
- Bobcats

PRACTICAL. AFFORDABLE. TRANSFORMATIVE.

- 100% Practical Training
- Industry Standard Equipment
- Internship & Job Placement Support
- Entrepreneurship Development
- Building Strong Communities
- Creating Independent Futures

From Skills To Success.
From Training To Transformation.
From You To Your Future.

OUR MISSION

To equip young men and women with practical skills, knowledge and values that empower them to build successful careers, grow sustainable businesses and transform their communities.

Focused on hands-on education and workforce development, **Lofa Practical College** is designed to provide real-world technical training that prepares students for skilled careers in construction, mining, mechanics, electrical systems, plumbing, welding, business, and heavy equipment operations. The campus features modern classrooms, workshops, equipment training yards, construction practice areas, and industry-focused learning centers that combine practical experience with technical education. The college is structured to support job-ready graduates through hands-on training, modern equipment, experienced instructors, and entrepreneurship development. Programs include automotive mechanics, road construction, roofing, carpentry, mining operations, electrical systems, renewable energy, and business management, helping students build practical skills for employment and community development across Liberia.



LOFA GOVERNMENT COMPLEX

SERVING LIBERIA. BUILDING TRUST. DELIVERING RESULTS.

STRATEGIC LOCATION: JUST OUTSIDE THE CBD DISTRICT – ACCESSIBLE, SECURE & DESIGNED FOR THE FUTURE

A MODERN GOVERNMENT HUB DESIGNED TO IMPROVE SERVICE DELIVERY, TRANSPARENCY AND ACCOUNTABILITY WHILE PROVIDING WORLD-CLASS FACILITIES FOR PUBLIC AND ADMINISTRATIVE USE.

- WHY OUTSIDE THE CBD?**
- Less congestion for efficient operations
 - More space for expansion
 - Better security and traffic flow
 - Modern infrastructure and environment



MINISTRY OF FINANCE & ECONOMIC PLANNING
Budgeting, Revenue, National Planning & Economic Policy

EXECUTIVE & ADMINISTRATION BUILDING
Office of the President, Cabinet Offices & Executive Secretariat

MINISTRY OF FOREIGN AFFAIRS & INTERNATIONAL COOPERATION
Diplomacy, International Relations & Consular Services

NATIONAL ASSEMBLY & SENATE BUILDING
Legislative Chambers, Committees & Offices

MINISTRY OF JUSTICE & ATTORNEY GENERAL
Legal Affairs, Prosecution & Justice Administration

CITIZEN SERVICE CENTER
One-Stop-Shop for Public Services, Permits, IDs, Business Registration & Inquiries

MINISTRY OF INTERNAL AFFAIRS & SECURITY SERVICES
Internal Security, Immigration, Disaster Management

AUDITOR GENERAL & ANTI-CORRUPTION COMMISSION
Audits, Integrity, Investigations & Compliance

- EFFICIENT GOVERNANCE**
All key ministries and agencies under one integrated campus.
- PUBLIC ACCESS**
Easy access for citizens with modern service centers.
- TRANSPARENCY & ACCOUNTABILITY**
Open, digital and citizen-focused government operations.
- SUSTAINABLE & SECURE**
Green buildings, renewable energy, 24/7 security and smart systems.

Lofa Government Complex.

Modern government and administrative campus planned for Liberia. The development is designed to centralize key ministries, public agencies, and citizen services into one secure and efficient location focused on transparency, accessibility, and improved public service delivery.

At the center of the complex is the main executive and administrative building, surrounded by facilities for the Ministry of Finance, Ministry of Justice, Foreign Affairs, Internal Affairs, National Assembly, Senate, Auditor General, and a centralized Citizen Service Center. The campus features modern architecture, landscaped green spaces, organized roadways, parking areas, fountains, and solar-ready infrastructure. The project also includes smart government systems such as digital services, e-government platforms, secure access control, conference and training facilities, and modern public service halls where citizens can access permits, IDs, passports, tax services, and legal documentation in one location.

Overall, the Lofa Government Complex is presented as a future-ready government hub designed to improve efficiency, coordination, sustainability, security, and national development while creating a modern public administration center for Liberia.

- SERVICES TO THE PUBLIC**
- Government Information & Inquiries
 - ID Cards, Passports & Civil Services
 - Business Registration & Licensing
 - Tax Services & Payments
 - Notarization & Legal Services
 - Social Services & Benefits
 - Grievance & Feedback Desk

- SMART & MODERN FACILITIES**
- High-speed digital infrastructure
 - Integrated e-Government systems
 - Video conferencing & smart meeting rooms
 - Digital document management
 - Accessible for persons with disabilities
 - 24/7 security, CCTV & gated access
 - Ample parking & green landscaping

GRAND PLAZA & CEREMONIAL SQUARE
A symbol of unity and national pride for official events and gatherings.

PUBLIC SERVICE HALL
Comfortable, modern and efficient space for citizens to receive services.

CONFERENCE & TRAINING CENTER
Building capacity through training, workshops and national dialogue.

- KEY BENEFITS**
- Improved service delivery and citizen satisfaction
 - Stronger coordination across ministries
 - Cost-effective operations in one integrated campus
 - Supports national development and good governance
 - Future-ready for growth and innovation

INTEGRATED GOVERNANCE
All key institutions working together for a stronger Liberia.

PEOPLE FIRST
Designed to serve citizens with dignity and respect.

OUR COMMITMENT
A government that is transparent, efficient, inclusive and accountable to every Liberian.

SUSTAINABLE DESIGN
Energy-efficient buildings, solar power and green spaces for a better tomorrow.

BUILDING A BETTER LIBERIA
Strong institutions. Strong nation. Stronger future.

LOFA INDUSTRIAL PARK & HUB

SMART • CONNECTED • SUSTAINABLE • FUTURE-READY

A modern industrial & business hub designed for productivity, growth, and long-term success.

- Reliable utilities
- Power backup options
- High-speed connectivity
- Easy access & logistics

- Modern Warehouses & Factories
- Logistics & Distribution Center
- Business Offices & Co-working
- Utilities & Power Substation
- Worker Facilities & Amenities
- Green Spaces & Landscaping

KEY FEATURES

- Modern Industrial Infrastructure
- 24/7 Security & CCTV
- Reliable Power & Backup
- Water Supply & Drainage
- High-Speed Internet
- Sustainable & Green Environment
- Wide Roads & Easy Accessibility
- Skilled Workforce & Support Services
- One-Stop Business Support



STRATEGIC LOCATION

Excellent Access to Major Routes



HIGH GROWTH POTENTIAL

Ideal for Investment & Expansion



SMART INFRASTRUCTURE

Built for Efficiency & Productivity



SUSTAINABLE DEVELOPMENT

Eco-Friendly & Future Focused



INVESTOR FRIENDLY

Business Support & Incentives



SAFE & SECURE ENVIRONMENT

24/7 Security & Surveillance

Lofa Industrial Park and Hub is a modern master-planned industrial and commercial development designed to support long-term economic growth, manufacturing, logistics, warehousing, and business expansion in Lofa County, Liberia. The development features wide access roads, modern warehouse facilities, office spaces, logistics centers, truck access routes, renewable energy infrastructure, and integrated utility systems designed for operational efficiency and scalability.

The project is planned as a future-ready business ecosystem with reliable utilities, renewable power backup systems, high-speed connectivity, water treatment infrastructure, security systems, and green landscaped corridors throughout the park. Designed to attract local and international investors, the industrial hub will support manufacturing, distribution, agro-processing, construction materials, technology services, and regional trade operations. Lofa Industrial Park and Hub is envisioned as a catalyst for employment, infrastructure development, and economic transformation in the region by creating a centralized location for industrial operations, commercial services, training facilities, logistics support, and sustainable business growth.

1 WATER TREATMENT & DISTRIBUTION FACILITY



Advanced facility for clean water production, storage and reliable distribution across residential, industrial and commercial zones.

- WATER SUPPLY: TREATMENT PLANT + DISTRIBUTION NETWORK**
Advanced filtration, desalination (if required) and safe distribution to all facility zones.
- SEWERAGE & WASTEWATER: TREATMENT & RECYCLING PLANT**
Modern sewage treatment and recycling system for sustainable water reuse.
- SOLID WASTE MANAGEMENT: RECYCLING & WASTE-TO-ENERGY**
Integrated solid waste handling, recycling and waste-to-energy solutions.

- KEY FEATURES**
- ✓ High Capacity & Efficiency
 - ✓ Automated Operations
 - ✓ Water Quality Monitoring
 - ✓ Sustainable Resource Use
 - ✓ Energy Efficient Systems
 - ✓ Environmental Protection

2 ADVANCED WASTE MANAGEMENT & RESOURCE RECOVERY FACILITY



State-of-the-art facility for waste processing, recycling and energy recovery that supports a circular economy and cleaner environment.

- RECYCLING CENTER**
Sorting, processing and recycling of municipal and industrial waste.
- WASTE-TO-ENERGY PLANT**
Converts non-recyclable waste into clean, renewable energy.
- SANITARY LANDFILL**
Engineered landfill for safe disposal with environmental protection.

- KEY FEATURES**
- ✓ High Recycling Rate
 - ✓ Energy Recovery System
 - ✓ Emission Control Technology
 - ✓ Safe Waste Disposal
 - ✓ Environmental Compliance
 - ✓ Community Health Protection

3 RECYCLING CENTRE – PAPER, PLASTIC, GLASS & CAR TIRES



Specialized recycling centre to sort, process and repurpose materials for a cleaner environment and stronger economy.

- PAPER RECYCLING**
Collection, sorting and processing of paper waste into reusable materials.
- GLASS RECYCLING**
Crushing and melting of glass for repurposing and new production.
- PLASTIC RECYCLING**
Cleaning, shredding and reprocessing plastic for new products.
- CAR TIRE RECYCLING**
Shredding and recycling of tires into rubber, fuel or new tire products.

- KEY FEATURES**
- ✓ Material Recovery
 - ✓ Resource Efficiency
 - ✓ Waste Reduction
 - ✓ Circular Economy
 - ✓ Job Creation
 - ✓ Cleaner Environment

INTEGRATED BENEFITS ACROSS ALL FACILITIES

- INTEGRATED SYSTEMS**
Seamlessly connected facilities for maximum efficiency and reliability.
- SMART & SECURE OPERATIONS**
24/7 CCTV Surveillance
Access Control
Perimeter Security
Smart Monitoring
- CONNECTIVITY & ACCESS**
Internal Road Network
Direct Highway Access
Logistics Corridor
Staff & Visitor Parking
- SUSTAINABLE & ENVIRONMENTALLY RESPONSIBLE**
Renewable Energy
Green Landscaping
Water Management
Energy Efficient Operations
- ECONOMIC & SOCIAL IMPACT**
Job Creation
Skills Development
Community Empowerment
Healthy Environment

- CLEAN WATER FOR COMMUNITIES**
Reliable supply for homes, businesses and industries.
- WASTE INTO VALUE & ENERGY**
Turning waste into resources and clean energy.
- CIRCULAR ECONOMY IN ACTION**
Reduce. Reuse. Recycle. Sustainable for the future.
- A CLEANER, GREENER LIBERIA**
Protecting our environment for generations.
- DRIVING GROWTH & DEVELOPMENT**
Building infrastructure today for a stronger tomorrow.

<p>WELL-PLANNED INFRASTRUCTURE Modern roads, drainage and utility corridors for smooth traffic and operations.</p>	<p>SOLAR CANOPY PARKING Clean energy generation with shaded parking for staff and visitors.</p>
<p>SECURE & CONTROLLED ACCESS Advanced access control for safety, security and operational efficiency.</p>	<p>GREEN & SUSTAINABLE LANDSCAPING Eco-friendly landscaping for a cleaner, healthier and more beautiful environment.</p>

- PARTNERSHIP & COLLABORATION**
Building strong partnerships for shared success.
- INNOVATION & TECHNOLOGY**
Modern solutions for smarter, cleaner and better operations.
- QUALITY & EXCELLENCE**
Highest standards in design, construction and operations.
- GLOBAL STANDARDS, LOCAL IMPACT**
International standards with a local commitment.

INTEGRATED INFRASTRUCTURE. SUSTAINABLE TOMORROW. STRONGER LIBERIA.

LOFA RECYCLING CENTRE

PAPER • PLASTIC • GLASS • CARDBOARD

SUSTAINABLE SOLUTIONS FOR A CLEANER LIBERIA



Reduce Waste
Diverting recyclable materials from landfill.



Conserve Resources
Reusing materials to save natural resources.



Create Value
Turning waste into new opportunities.



Clean Environment
Building a healthier future for our communities.



Stronger Economy
Generating jobs and supporting local growth.



MATERIAL PROCESS FLOW



1 COLLECTION
Materials collected from homes, businesses and industries.



2 SORTING
Materials are sorted by type for purity and quality.



3 PROCESSING
Materials are cleaned, shredded and prepared for recycling.



4 BALING & STORAGE
Processed materials are baled and stored for transport.



5 REPURPOSING
Materials are sent to manufacturers to be reused in new products.

WE ACCEPT

PAPER



Newspapers, office paper, magazines, mixed paper, books and brochures.

PLASTIC



PET bottles, plastic containers, jugs, packaging, films and plastic bags.

GLASS



Bottles, jars, containers and glass packaging (all colors).

CARDBOARD



Cardboard boxes, corrugated board, cartons and paper packaging.

FACILITY FEATURES

- ✓ Advanced sorting & processing technology
- ✓ High efficiency material recovery
- ✓ Dust & emission control systems
- ✓ Rainwater harvesting & solar energy
- ✓ Safe working environment
- ✓ Community education & awareness



Lofa Recycling Centre, a modern recycling and waste recovery facility planned for Liberia. The center is designed to process paper, plastic, glass, and cardboard while promoting environmental sustainability, cleaner communities, and local economic growth.

The facility features large industrial processing bays with conveyor systems, truck loading areas, storage zones, and organized material handling operations. Separate sections are dedicated to paper, plastic, glass, and cardboard recycling, allowing materials to be sorted, cleaned, processed, baled, and prepared for reuse in manufacturing and new products. The presentation also highlights the recycling process flow, beginning with collection and sorting, followed by processing, storage, and repurposing. The center is designed to accept a wide range of recyclable materials from homes, businesses, and industries throughout the region.

Additional features include advanced sorting technology, solar energy systems, rainwater harvesting, emission control systems, and safe working environments. Overall, the project is positioned as a modern environmental infrastructure development aimed at reducing landfill waste, creating jobs, supporting education, and building a cleaner and more sustainable future for Liberia.



BUILDING A CLEANER LIBERIA
TOGETHER WE RECYCLE.
TOGETHER WE GROW.



ENVIRONMENTAL PROTECTION
Reducing pollution and protecting our planet.



COMMUNITY IMPACT
Creating jobs, supporting education and improving lives.



LOFA INTERNATIONAL INFRASTRUCTURE GROUP

CONNECTING LIBERIA. EMPOWERING REGIONS.

LOFA RECYCLING CENTRE

TURNING WASTE INTO CLEAN ENERGY, VALUABLE RESOURCES & A SUSTAINABLE FUTURE

OUR MISSION

To transform waste tires into clean energy and valuable by-products through advanced recycling technology, creating environmental solutions and economic opportunities for Luther County and Liberia.



ENVIRONMENTAL PROTECTION

Reducing waste and preventing pollution.



CLEAN ENERGY PRODUCTION

Converting waste into hydrogen and usable oil.



RESOURCE RECOVERY

Recovering metal, carbon black, oil and other materials.



COMMUNITY DEVELOPMENT

Creating green jobs and supporting local economies.



A SUSTAINABLE FUTURE

Building a cleaner, healthier Liberia for generations to come.

BENEFITS TO LIBERIA

- ✓ Reduces environmental pollution from discarded tires
- ✓ Produces clean hydrogen fuel for energy and transportation
- ✓ Generates usable oil for industrial and commercial use
- ✓ Recovers valuable metals for recycling and reuse
- ✓ Creates green jobs and supports economic growth
- ✓ Strengthens Liberia's path to a sustainable future

OUR PRODUCTS



HYDROGEN GAS
Clean, renewable fuel for a sustainable energy future.



USABLE OIL
High-quality oil for industrial boilers, generators and more.



CARBON BLACK
Used in tires, plastics, rubber and other manufacturing.



STEEL & METALS
Recycled metal wires and steel for new industrial products.

HOW WE WORK

We use state-of-the-art pyrolysis technology to break down waste tires in a controlled, oxygen-free environment. This process converts tires into hydrogen gas, usable oil, recovered carbon black, and clean steel—reducing waste and creating valuable resources.



1. TIRE COLLECTION
Waste tires are collected from communities, businesses, and service centers.



2. SHREDDING & PREPARATION
Tires are shredded into small pieces for efficient processing.



3. PYROLYSIS PROCESS
Tires are heated in an oxygen-free environment, breaking them down into gas, oil, carbon black and steel.



HYDROGEN GAS
Clean energy for power generation and transportation



USABLE OIL
Refined for industrial and commercial use



CARBON BLACK
Reused in manufacturing new products



STEEL & METALS
Separated and recycled for reuse in industries



4. STORAGE & REFINEMENT
Products are cleaned, stored safely and prepared for distribution and use.



5. A CLEANER FUTURE
Turning waste into value, powering Liberia's future with clean energy and sustainable solutions.

TIRE SHREDDING & PREPARATION

THERMAL CONVERSION (PYROLYSIS) PLANT

GAS CLEANING & REFINEMENT SYSTEM

HYDROGEN STORAGE

TIRE COLLECTION & RECEIVING

STEEL & METAL SEPARATION

CARBON BLACK RECOVERY

OIL STORAGE & LOADING

LOFA RECYCLING CENTRE

OUR ADVANCED RECYCLING PROCESS



SAFE & CLEAN TECHNOLOGY
Advanced systems ensure zero harmful emissions and a safe working environment.



ENVIRONMENTALLY RESPONSIBLE
We prevent tire dumping and open burning, protecting our land, air and water.



BUILDING A GREEN ECONOMY
Investing in green technology to create jobs, skills and long-term prosperity for our communities.



TOGETHER FOR LIBERIA
A partnership between industry, government and communities for a sustainable Liberia.



LOFA INTERNATIONAL INFRASTRUCTURE GROUP

CONNECTING LIBERIA. EMPOWERING REGIONS.

Lofa Recycling Centre,

A modern waste-to-energy and recycling facility designed to transform used tires and waste materials into valuable resources and clean energy products. The facility uses advanced pyrolysis and recycling technology to process tires into hydrogen gas, usable industrial oil, carbon black, and recycled steel and metals. The project is focused on reducing pollution, creating jobs, supporting environmental sustainability, and helping build a cleaner and more energy-independent future for Liberia through modern green infrastructure and resource recovery systems.

LOFA WASTEWATER TREATMENT PLANT

STATE-OF-THE-ART TECHNOLOGY FOR A CLEANER LIBERIA

Protecting Water. Protecting Communities. Building a Sustainable Future.

TREATMENT PROCESS FLOW

1 INFLUENT & SCREENING

Raw wastewater enters the plant and is screened to remove large solids and debris.

2 PRIMARY TREATMENT

Sedimentation tanks remove suspended solids and reduce organic load.

3 BIOLOGICAL TREATMENT

Advanced aeration basins use biological processes to break down organic matter.

4 SECONDARY CLARIFICATION

Clarifiers separate treated water from biomass for high-quality effluent.

5 TERTIARY FILTRATION & DISINFECTION

Filtration and UV disinfection ensure safe, clean water before discharge or reuse.

6 CLEAN WATER OUTPUT

Treated water is discharged safely or reused for irrigation and industrial use.



ADVANCED TREATMENT

Multi-stage process ensures high-quality effluent that meets international standards.



ENERGY EFFICIENT

High-efficiency blowers, pumps, and solar power reduce energy use and operating costs.



RESOURCE RECOVERY

Biosolids are treated and converted into beneficial use products for agriculture and landscaping.



ENVIRONMENTAL PROTECTION

Designed to protect local waterways, reduce pollution, and support a healthier environment.



SMART OPERATIONS

SCADA system enables real-time monitoring, control, and predictive maintenance.



SUSTAINABLE FUTURE

Supporting community health, water reuse, and long-term sustainability for Liberia.



STATE-OF-THE-ART TECHNOLOGY

Engineered for reliability, efficiency and long-term performance.



BUILT FOR LIBERIA

Designed to meet local needs and support national development.



SAFE. CLEAN. SUSTAINABLE.

Working together for a cleaner environment and stronger communities.



LOFA INFRASTRUCTURE GROUP

BUILDING A CLEANER, STRONGER LIBERIA.

Lofa Wastewater Treatment Plant

demonstrates how advanced water treatment technology can support cleaner communities, public health, and long-term sustainable development in Liberia. The facility is carefully planned with multiple treatment stages that transform raw wastewater into clean, reusable water through screening, biological treatment, clarification, filtration, and UV disinfection systems.

The image shows a large-scale treatment campus with primary and secondary clarifiers, aeration basins, sludge digestion systems, biosolid processing areas, clean water storage tanks, and centralized SCADA monitoring and control facilities. Solar panels and energy-efficient systems are integrated throughout the site, highlighting the plant's focus on sustainability, operational efficiency, and reduced environmental impact.

The treatment process is designed to protect local waterways by reducing pollution and safely treating wastewater before discharge or reuse. In addition to producing clean water, the facility also recovers useful biosolids for agricultural and landscaping applications. Overall, the project represents a future-focused utility development intended to improve sanitation, environmental protection, water reuse, and community health while supporting Liberia's growing infrastructure needs.



PROJECT

Lofa Co-op

Service & Training



TOGETHER WE GROW. TOGETHER WE PROSPER.

HOW IT WORKS

1. WE PROVIDE TRAINING & EQUIPMENT

- Mining & Safety Training
- Farming & Best Practices
- Business & Financial Management
- Tools, Equipment & Protective Gear



LOFA CO-OP
SERVICE & TRAINING

Empowering our people.
Building our future.

2. YOU PRODUCE MINING & FARM PRODUCTS

MINING

- Diamonds
- Gold

FARMING

- Fresh Vegetables
- Grains & Staples
- Other Farm Produce

OUR COMMITMENT

We are committed to building skills, creating opportunities, and improving lives through partnership and trust.

WHAT WE OFFER

- PRACTICAL TRAINING**
- QUALITY EQUIPMENT**
- ONGOING SUPPORT**
- SUSTAINABLE GROWTH**

4. YOU RECEIVE FAIR PAYMENT

3. SELL BACK TO THE CO-OP

You sell your diamonds, gold and farmed food back to the co-op.

TRAINED. EQUIPPED. EMPOWERED.

PRODUCE. SELL. PROSPER.

TOGETHER, WE BUILD A BETTER LOFA.

LOFA GRAND MALL

LOFA COUNTY, LIBERIA

Modern • Sustainable • Community Focused

PROJECT OVERVIEW

- 4-Level Mixed Use Shopping Mall
- Retail, Offices, Hotel, Entertainment
- Sustainable Design with Solar Power
- Modern African Architecture
- Built for Community & Growth



Lofo Grand Mall, a modern mixed-use development planned for Lofa County, Liberia. The project combines shopping, entertainment, offices, hospitality, and renewable energy systems into a large community-focused commercial center designed to support long-term economic growth.

The mall features a contemporary African-inspired design with glass facades, open atriums, rooftop solar panels, landscaped walkways, fountains, and organized parking areas. The development includes retail stores, supermarkets, restaurants, cinemas, offices, clinics, conference facilities, children's play areas, hotel suites, and rooftop gardens, creating a full lifestyle and business destination.

The floor plans show a well-organized layout with retail and food services on the ground floor, offices and healthcare on the second floor, and entertainment and conference spaces on the upper levels. The rooftop integrates solar energy systems and outdoor leisure areas, highlighting the project's focus on sustainability and smart infrastructure. Overall, the project is designed to become a major regional hub for commerce, tourism, business, and community development while promoting renewable energy, local job creation, and modern urban growth in northern Liberia.

FACILITIES

- Supermarket & Wholesale
- Retail Stores
- Food Court & Restaurants
- Cinema
- Hotel & Suites
- Offices & Co-working
- Banking & ATM
- Pharmacy & Clinic
- Conference Center
- Children Play Zone
- Parking (Ground & Basement)
- Solar Energy System
- EV Charging Stations
- Bus / Taxi Terminal
- Rooftop Garden & Lounge

FLOOR PLANS

GROUND FLOOR PLAN



SECOND FLOOR PLAN

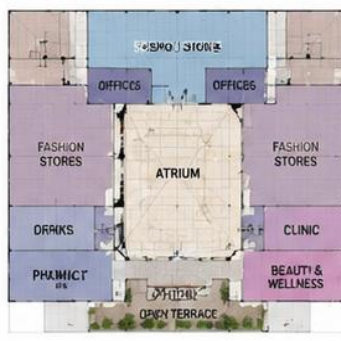

THIRD FLOOR PLAN



ROOFTOP PLAN



SITE PLAN



MALL SECTION VIEW



KEY HIGHLIGHTS

- SUSTAINABLE ENERGY**
Solar Power + Backup Hydrogen System
- WATER MANAGEMENT**
Rainwater Harvesting & Recycling
- SMART BUILDING**
Automation, Security & High-Speed Internet
- GREEN DESIGN**
Natural Ventilation & Green Spaces
- COMMUNITY FOCUSED**
Jobs, Training, Local Business Support
- ACCESSIBILITY**
Disabled Access, Elevators, Escalators

LOFA MALL ONE

LOFA COUNTY, LIBERIA

Modern • Sustainable • Community Focused

PROJECT OVERVIEW

- All Ground Level Construction
- Modern Shopping Mall with 100% Solar Coverage
- Retail, Offices, Hotel, Entertainment
- Sustainable Design with Solar Power
- Built for Community & Growth



- ### FACILITIES
- Shopping Cart icon: Supermarket & Wholesale
 - Shopping Bag icon: Retail Stores
 - Fork and Knife icon: Food Court & Restaurants
 - Cinema icon: Cinema
 - Hotel icon: Hotel & Suites
 - Office icon: Offices & Co-working
 - ATM icon: Banking & ATM
 - Medical icon: Pharmacy & Clinic
 - Group of people icon: Conference Center
 - Child icon: Children Play Zone
 - P icon: Parking (Ground & Solar)
 - Solar icon: Solar Energy System
 - EV icon: EV Charging Stations
 - Bus icon: Bus / Taxi Terminal
 - Plant icon: Rooftop Garden & Lounge

FLOOR PLAN (GROUND LEVEL)

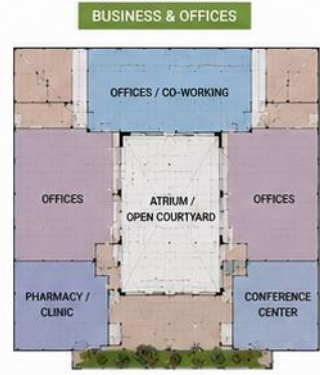
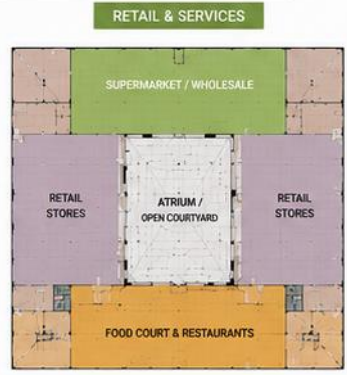

SITE PLAN



KEY HIGHLIGHTS

- SUSTAINABLE ENERGY**: 100% Solar Powered Parking & Facilities
- WATER MANAGEMENT**: Rainwater Harvesting & Recycling
- SMART BUILDING**: Automation, Security & High-Speed Internet
- GREEN DESIGN**: Natural Ventilation & Green Spaces
- COMMUNITY FOCUSED**: Jobs, Training, Local Business Support
- ACCESSIBILITY**: Disabled Access, Ramps & Pathways

Multiple regional malls threw out the development



Designed as a modern transportation hub for northern Liberia, the **Lofo International Airport** is planned to improve regional connectivity, passenger travel, cargo logistics, and economic growth. The airport features a modern international terminal, cargo facilities, maintenance hangars, helicopter pads, a control tower, and a 3,200-meter runway capable of supporting commercial and regional aviation operations. The development also integrates renewable energy through large solar canopy parking systems, energy-efficient buildings, advanced security infrastructure, CCTV monitoring, and controlled access points. Organized roadways, parking areas, and landscaped surroundings create a secure and future-ready aviation environment. Overall, the project is designed to support tourism, business, transportation, emergency services, and regional development while strengthening Liberia's long-term infrastructure and economic expansion.



KEY FEATURES	
	3,200m x 60m Runway Night Landing Capability
	Modern Passenger Terminal International Standards
	Cargo Terminal Regional Logistics Hub
	Maintenance Hangars Full Aircraft Support
	5 Helicopter Pads Multi-Purpose Operations
	Control Tower Advanced Air Traffic Control
	Solar Panel Parking Sustainable Energy
	Secure Perimeter CCTV & Access Control



INTERNATIONAL TERMINAL



CARGO TERMINAL



MAINTENANCE HANGARS



CONTROL TOWER



HELICOPTER PADS



SOLAR PANEL PARKING

SECURITY & INFRASTRUCTURE	
	Perimeter Fencing
	CCTV Surveillance
	Perimeter Lighting
	Access Control Gates
	24/7 Security Operations
	Internal Road Network



LOFA INTERNATIONAL AIRPORT

CONNECTING PEOPLE. POWERING PROGRESS.

BASE-LOAD POWER PRODUCTION 100% GREEN ENERGY

SUSTAINABLE. RELIABLE. RENEWABLE.

Using the natural power of flowing river water to generate clean, reliable electricity 24/7

WEG ENERGY
RENEWABLE ENERGY LLC.



100% green hydroelectric base-load power system

developed by WEG Energy LLC that uses flowing river water to generate reliable renewable electricity 24/7. The system combines hydro turbines, generators, power control systems, and supercapacitor battery storage to provide stable clean energy ranging from small 250 kW units to multi-megawatt installations. The design shows how river water flows through Kaplan-style turbines to generate electricity before safely returning the water back to the river. Integrated supercapacitor storage helps stabilize power output, store excess energy, and provide backup support during peak demand. The system is designed to be scalable, grid-connected, environmentally friendly, and capable of delivering continuous renewable power for communities, industries, and remote locations.

1 RIVER WATER
into Hydro Turbine

A POWER PRODUCTION CAPACITY

- From 250kW unit to 500kW units per hour
- Large units from 1MW to 2.5MW (using multiple units can give large capacity)

2 RIVER WATER
out

POWER
TO THE GRID

B SUPER - CAPACITOR
BATTERY STORAGE
1 to 3MW

5 POWER CONTROL
PANEL / GENERATOR

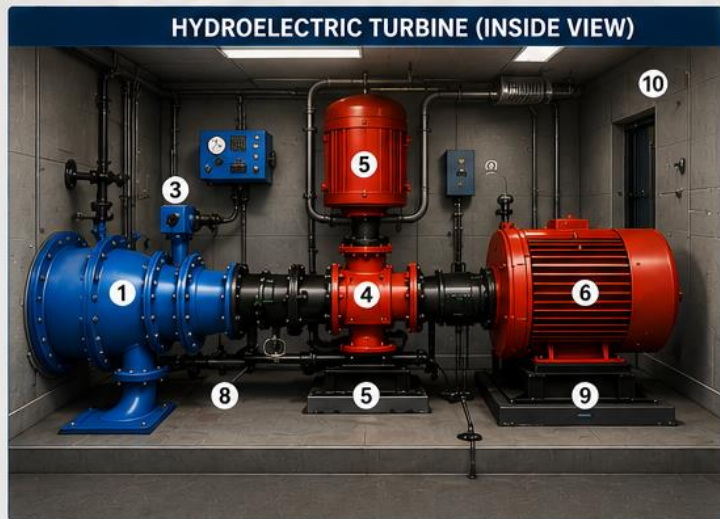

HYDROELECTRIC TURBINE (INSIDE VIEW)

- 1 Water Intake**
River water enters the system
- 2 Flow Regulation (Wicket Gates)**
Controls the water flow
- 3 Flow Regulation (By Wicket Gates)**
Adjusts flow to optimize turbine performance
- 4 Turbine**
Converts water energy to mechanical energy
- 5 Pressure Regulator / Governor**
Maintains stable pressure and speed
- 6 Generator**
Converts mechanical energy to electricity
- 7 Power Output**
Electricity output to control system
- 8 Water Discharge**
Water flows back to the river
- 9 Base / Mounting**
Secure equipment installation
- 10 Ventilation**
Ensures proper airflow and cooling

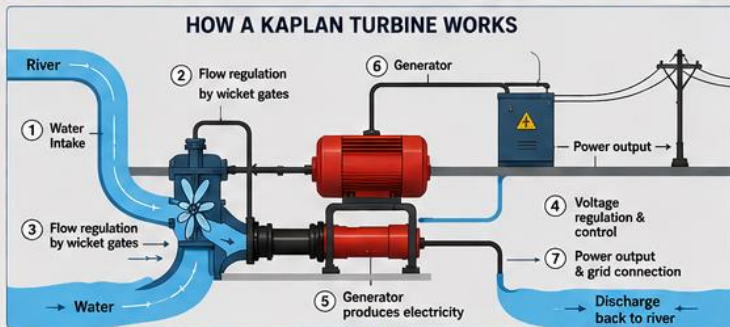

- Stable & Reliable Power Output
- Stores Excess Energy
- Provides Backup During Peak Demand
- Ensures Continuous Power Supply

100% RENEWABLE
Clean energy from flowing water

RELIABLE & STABLE
Consistent base-load power 24/7

SCALABLE CAPACITY
From 250kW to 2.5MW+ using multiple units

ENERGY STORAGE
Super-capacitor storage for maximum reliability

GRID CONNECTED
Clean power to the grid

WATER FRIENDLY
Returns water to the river

A GREENER FUTURE
Sustainable power for generations to come

WEG Energy integrated renewable power solution, combining a **300 × 740W solar system (222 kW DC)** with supporting infrastructure such as **inverters, transformers, grid connection, and supercapacitor energy storage**. On the right, a detailed infographic outlines energy production estimates for Suriname, including daily, monthly, and annual output, along with land requirements and system benefits. On the left and center, visual components show EV charging stations, a wind turbine, containerized power units with solar panels, and modular energy storage systems, all interconnected to form a **hybrid, scalable energy network**. Overall, the image illustrates a complete **clean energy ecosystem designed for efficient power generation, storage, and distribution**, suitable for residential, commercial, and infrastructure applications.

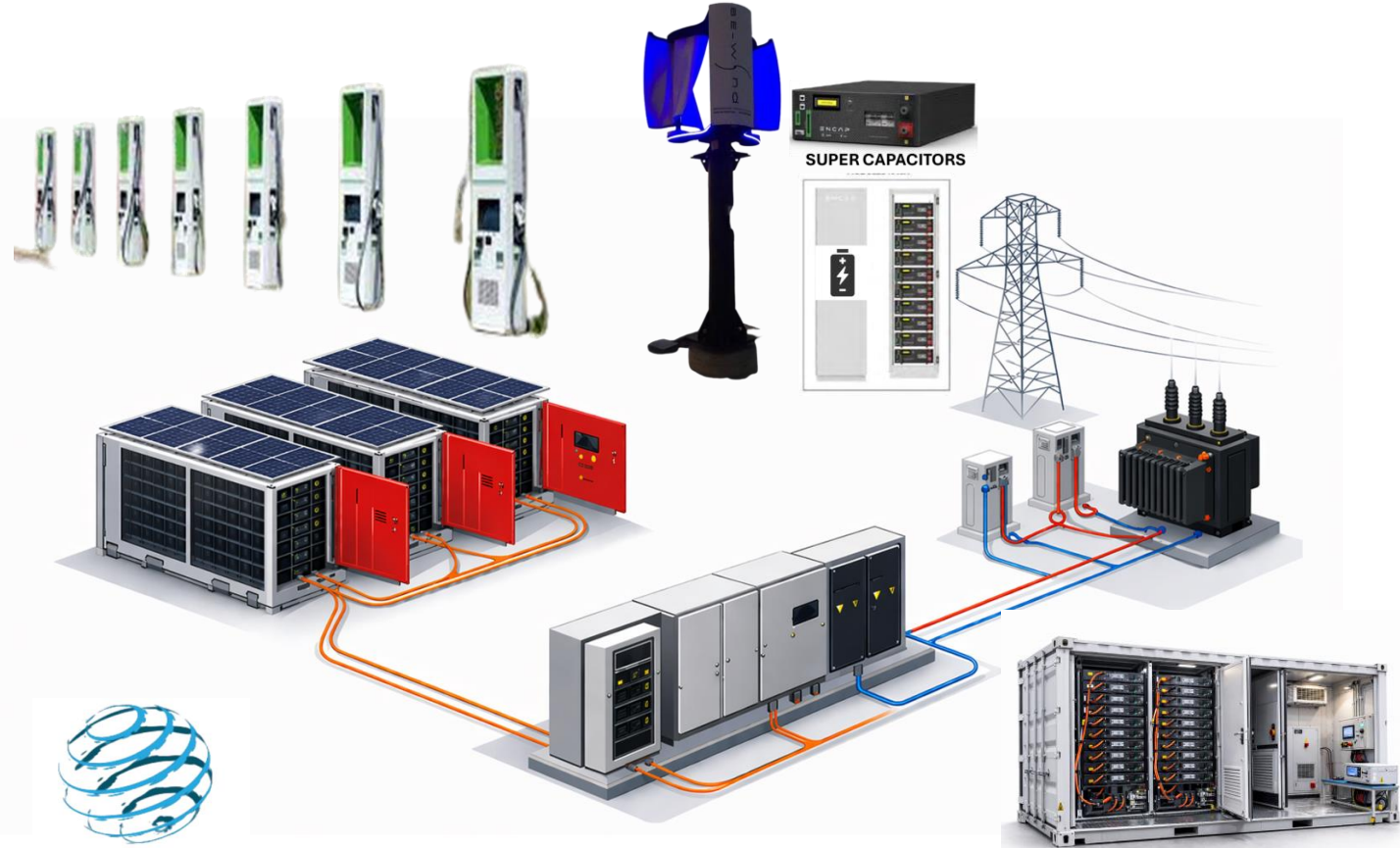

300 × 740W SOLAR SYSTEM

POWERING A SUSTAINABLE FUTURE IN LIBERIA

High-performance solar solution delivering clean, reliable, and cost-effective energy.



1. SYSTEM CAPACITY

300 × 740W PANELS
TOTAL INSTALLED CAPACITY
222 kW DC
222,000 W (DC)

CLEAN ENERGY 100% Renewable and Sustainable	HIGH PERFORMANCE Strong solar irradiance 5.0 – 5.5 peak sun hours per day	LOWER COSTS Reduce energy expenses and diesel dependency	RELIABLE & SCALABLE Built for long-term performance and future expansion
---	---	--	--

2. ENERGY PRODUCTION ESTIMATES (LIBERIA)

Liberia has strong solar irradiation, averaging 5.0 – 5.5 peak sun hours per day.

CONSERVATIVE ESTIMATE 222 kW × 5.0 hrs	1,110 kWh/day
HIGH-END ESTIMATE 222 kW × 5.5 hrs	1,221 kWh/day
REALISTIC OUTPUT (AFTER LOSSES) Accounting for ~10–15% system losses (heat, inverter, dust, wiring, etc.)	~950 – 1,050 kWh/day EXPECTED NET OUTPUT

3. MONTHLY & ANNUAL ENERGY PRODUCTION

MONTHLY PRODUCTION
~28,000 – 31,000 kWh

ANNUAL PRODUCTION
~340,000 – 375,000 kWh

4. LAND & SPACE REQUIREMENTS

PANEL FOOTPRINT
Each 740W panel requires approximately 3.0 – 3.2 m²
Total panel area:
~930 m² (≈ 10,000 ft²)

TOTAL GROUND AREA
Including spacing, tilt, maintenance aisles, inverter area, cable access, etc.

RECOMMENDED SITE AREA:
2,000 – 3,000 m²

0.5 – 0.75 ACRES **0.20 – 0.30 HECTARES**

5. INTEGRATED SYSTEM COMPONENTS



6. SYSTEM PERFORMANCE CONTEXT

RESIDENTIAL SUPPLY
Powering approximately 80 – 120 homes (depending on consumption)

COMMERCIAL APPLICATIONS
Ideal for small commercial facilities, hotel energy offset, industrial loads, and mixed-use developments.

7. KEY BENEFITS

- Reliable renewable energy in a high-irradiance region
- Reduced dependency on diesel or grid instability
- Lower operational costs and long-term savings
- Scalable infrastructure for future growth
- Supports sustainability and ESG goals

8. AT A GLANCE

System Size	300 × 740W Panels
Total Capacity (DC)	222 kW
Daily Output (Net)	~950 – 1,050 kWh/day
Monthly Output	~28,000 – 31,000 kWh
Annual Output	~340,000 – 375,000 kWh
Land Required	2,000 – 3,000 m ² (0.5 – 0.75 acres)

CLEAN ENERGY. STRONGER COMMUNITIES. BRIGHTER FUTURE.
BUILDING A GREENER LIBERIA TOGETHER.





Hydrogen Power Plant

Going green power

90 MW Combined-Cycle Hydrogen Power Project
 You are viewing WEG Energy's 90-megawatt combined-cycle hydrogen power project. **93MW PLUS ELECTRICAL POWER FROM HYDROGEN**

Below are our modular hydrogen fuel production units, supplied by our OEM manufacturing partner. These containerized systems produce green hydrogen in real time, designed for scalable, utility-grade deployment. To the right is the Siemens SGT-800 hydrogen turbine, configured in a combined-cycle arrangement for high-efficiency power generation and continuous baseload capability.

- Integrated System Overview**
- Hydrogen is produced on site using modular fuel production units
 - Hydrogen is compressed and stored in secure storage systems
 - Hydrogen is distributed through a controlled fuel management network.
 - Hydrogen is fed directly to the turbine in real-time
 - The turbine generates reliable, high-availability electrical power.

This fully integrated system provides clean, firm power for industrial and infrastructure applications.

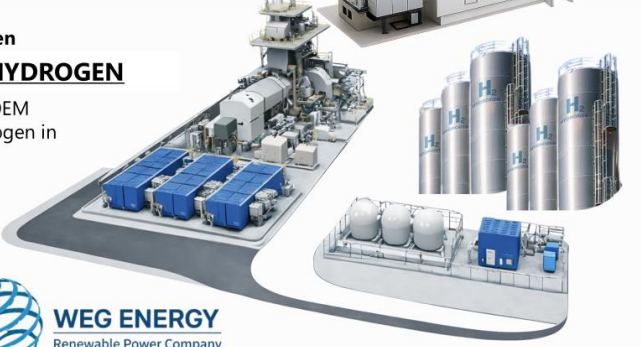

HYDROGEN ENGINE & GREEN H2 FUEL MADE ONSITE IN REAL-TIME / POWER OF GREEN SUSTAINABLE FUEL ENERGY INDEPENDENCES (WEG) – WATER ENERGY GROUP – H2 POWER BLOCK

HYDROGEN H₂



Converted to Electrical Power



Super-Cap Battery Storage

Fuel Production (based on efficiency approximately 3MW of fuel production per hour between the 2 units)

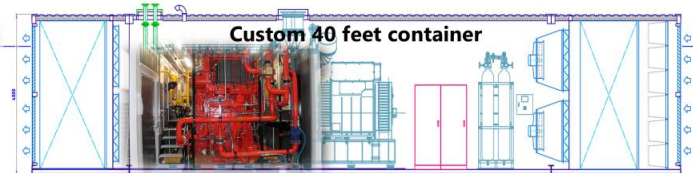

Hydrogen Engine Inside Inside our Green Container Hosting H2 Engine Making Green Power

WEG ENERGY LLC – 2 MW to 2.5 MW Hydrogen Power System Technical & Commercial Summary

WEG Energy LLC offers a containerized, modular hydrogen-to-power system designed to deliver reliable and scalable electrical power in both microgrid and grid-connected environments. The system operates on a fully integrated process that converts water into hydrogen through electrolysis, stores the hydrogen, and then utilizes fuel cell technology to generate electricity. This end-to-end solution provides a clean, efficient, and flexible energy platform suitable for a wide range of applications.

The system is available in two primary configurations. The preferred option is a fuel cell-based system delivering between 2 MW and 2.5 MW of electrical output at approximately 60% efficiency. Alternatively, a hybrid configuration can be deployed, combining fuel cells with a hydrogen-powered engine backup to enhance redundancy and operational resilience. All components are housed within standard 40-foot containers, which include hydrogen production units, fuel cells, control systems, and integrated cooling infrastructure, allowing for rapid deployment and modular scalability.

Hydrogen production is designed to meet continuous operational demand, with an estimated requirement of approximately 75 kg of hydrogen per hour per megawatt of output. This translates to roughly 150 kg/hour for a 2 MW system and 187.5 kg/hour for a 2.5 MW system.



<p>ELECTRIC VEHICLES</p>	<p>MOTORBIKES</p>	<p>BICYCLES</p>	<p>GOLF CARTS</p>
<p>100% RENEWABLE ENERGY POWERED</p>	<p>SAFE. SMART. RELIABLE.</p>	<p>SUPPORTING A GREENER PORT BOSKAMP</p>	<p>DRIVING A SUSTAINABLE FUTURE TOGETHER</p>



CHARGE STATIONS

All charge station are standalone using Solar panels and Wind turbines - OFFGRID – using super capacitors for energy storage. This project is totally renewable green energy



Solar Panels on main roof of charging station

- The Green movement to bring charge stations every 20 miles
- In Suriname looking to implement 4 units from day one at Port Boskamp.
- We can offer our solution to all – Electrical Bikes, Cars, Golf carts and Electrical Bicycle.



DATA CENTER & COMMUNICATIONS

At Lofa

ARE YOU READY FOR OUR PORTABLE DATA CENTER MODULES THE WITHSTAND CATEGORY 5 HURRICANE AND 8.0 EARTHQUAKE – BUT THAT NOT ALL WE ON OUR OWN 100 GREEN POWER ON OUR OWN GRID.

WE CUSTOMIZERS TO YOUR REQUIREMENT



Email: sales@wegenergygrp.com / Website: wegenergy.com



BUILT TO WITHSTAND NATURE

Engineered to withstand Category 5 Hurricane and 8.0 Earthquake.



100% GREEN POWER

Fully powered by our own clean energy – off-grid capable.



PORTABLE & MODULAR

Scalable, secure, and customizable to your data and communication needs.



SELF-SUFFICIENT. RELIABLE. RESILIENT.

Operate independently with continuous power and maximum uptime.



**POWERING PROGRESS.
PROTECTING OUR FUTURE.**

BUILDING A CLEAN ENERGY FUTURE FOR LOFA, LIBERIA

HYDROGEN TRANSPORTATION & FUEL DISTRIBUTION NETWORK

Clean Energy. Stronger Communities. Sustainable Liberia.

BENEFITS FOR LOFA

- Clean & Zero Emissions
- Energy Independence
- Job Creation & Local Investment
- Lower Operating Costs
- Stronger, Healthier Communities



- ### SERVING COMMUNITIES
- Reliable Energy
 - Modern Transportation
 - Industrial Growth
 - Agricultural Development
 - Better Quality of Life

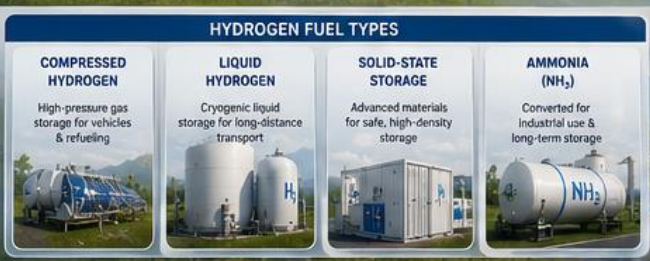

**CLEAN ENERGY TODAY
STRONGER LOFA TOMORROW**

**SUSTAINABLE
For Our Environment**

**RELIABLE
For Our Communities**

**INNOVATIVE
For Our Future**

**INCLUSIVE
For All**

LOFA
POWERING A GREENER LIBERIA

Powering Sustainable Agriculture with Green Hydrogen
Integrated Energy & Food Security Platform
Port Boskamp Development – Suriname

Clean Power. Controlled Growth. Regional Food Security.
WEG Energy has developed a next-generation integrated system designed to support **10,000 sq. ft. climate-controlled greenhouses**, each powered independently by dedicated hydrogen energy systems.

- This innovative platform combines:
- ✓ Green hydrogen fuel production
 - ✓ Dedicated pipeline distribution
 - ✓ Standalone 2.6 MW hydrogen generators
 - ✓ Cold storage & post-harvest facilities
 - ✓ Scalable agricultural expansion

How it Works:
Hydrogen fuel is produced on-site and delivered through a dedicated pipeline network to standalone **2.6 MW hydrogen power units**. Each greenhouse operates independently from the main Port Boskamp power plant, ensuring:

- Reliable 24/7 electrical power
 - Zero-emission energy generation
 - Noise-free operation
 - Energy security independent of grid fluctuations
- The same clean power supports refrigeration and cold storage facilities, preserving harvested crops and maintaining supply chain integrity.



THE WEG ENERGY CONCEPT FOR THE LOFA DEVELOPMENT IN LOFA IS A FULLY INTEGRATED GREEN HYDROGEN-POWERED AGRICULTURE AND ENERGY PLATFORM

Designed to deliver food security, clean energy, and scalable industrial growth. The system combines hydrogen production, dedicated distribution, and modular aeroponic greenhouses, each powered by independent **2.6 MW** hydrogen units, ensuring reliable, zero-emission 24/7 energy without reliance on the grid while supporting cold storage and post-harvest operations.

The agricultural system is built around high-density aeroponic greenhouse modules (30m x 100m) utilizing vertical growing towers to maximize yield and significantly reduce water usage. Each module includes integrated utility systems, climate control, and automated nutrient delivery, all designed for efficiency and scalability through a modular expansion approach.

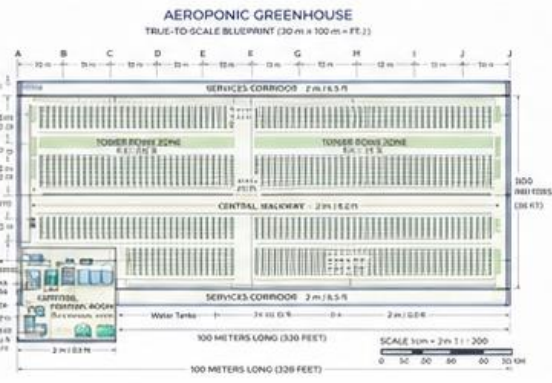
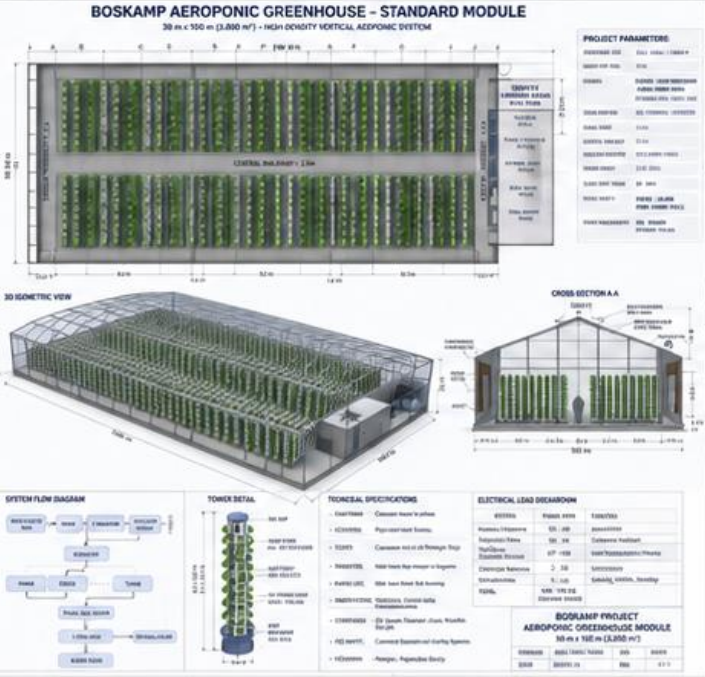



EXPANSION PLAN – 20 ADDITIONAL SELF-SUSTAINING VERTICAL GREENHOUSES

The plan is to add 20 additional self-sustaining vertical greenhouses (vertical farming) across 3 different locations as the city grows.



- ✓ Each location will have its own independent power system.
- ✓ Option to connect to the grid or operate completely off-grid.
- ✓ Provide food security for the masses at each location.
- ✓ Create employment for many and strengthen the local economy.
- ✓ Each location will include a food bank with cold storage to store and preserve excess produce for community support and long-term stability.

 <p>100% RENEWABLE Clean energy from flowing water</p>	 <p>RELIABLE & STABLE Consistent base-load power 24/7</p>	 <p>SCALABLE CAPACITY From 250kW to 2.5MW+ using multiple units</p>	 <p>ENERGY STORAGE Super-capacitor storage for maximum reliability</p>	 <p>GRID OPTIONAL Connect to the grid or remain independent</p>	 <p>COLD STORAGE & FOOD BANK Preserve harvests and support food security</p>	 <p>JOBS & COMMUNITY GROWTH Create jobs and build stronger communities</p>
--	---	---	--	---	--	--

A VISION FOR A SUSTAINABLE FUTURE – CLEAN ENERGY. FOOD SECURITY. STRONG COMMUNITIES.



CHANNEL



FUEL FEED FROM LOWER END (COAL, OIL OR NATURAL GAS)



ADVANCED TECHNOLOGY. SUSTAINABLE FUTURE.

-  State-of-the-Art Wet Process Technology
-  High Quality Raw Materials
-  Precision Process Control
-  Energy Efficient Operations
-  Environmental Stewardship

MODERN FLEET FOR RELIABLE DELIVERY



-  **CERMET BULK CEMENT TRUCKS**
For large scale and bulk deliveries.
-  **CERMET SILO TRUCKS**
For safe, strong and efficient bagged cement transportation.

OUR PREMIUM CEMENT



PORTLAND CEMENT (OPC)



PORTLAND POZZOLANA CEMENT (PPC)



ORDINARY PORTLAND CEMENT (OPC)

-  **CONSISTENT STRENGTH**
-  **SUPERIOR DURABILITY**
-  **PREMIUM QUALITY**
-  **BUILT FOR LIBERIA'S DEVELOPMENT**
-  **ENVIRONMENTALLY RESPONSIBLE**

Lofa Cement Company utilizes advanced wet-process cement manufacturing technology to produce high-quality cement products for infrastructure and construction development across Liberia and West Africa. The process begins with the crushing and preparation of limestone and clay materials, followed by precision blending, rotary kiln heating, clinker production, and final grinding to create premium cement products with consistent strength and durability. The facility is designed with modern equipment, energy-efficient systems, and environmentally responsible operations to support sustainable industrial growth. Supported by a reliable transportation fleet and modern logistics network, Lofa Cement Company delivers bulk and bagged cement solutions for residential, commercial, mining, and large-scale infrastructure projects while creating long-term employment and economic development opportunities for the region.

BUILDING STRONGER ROADS

ENGINEERED FOR DURABILITY. BUILT FOR THE FUTURE.

We use modern concrete road construction techniques, advanced equipment, and innovative materials like Basalt Fiber Reinforced Polymer (BFRP) rebar to deliver roads that last longer, require less maintenance, and withstand Liberia's toughest conditions.

WHY CONCRETE ROADS?

- ✓ Longer Service Life
- ✓ Low Maintenance
- ✓ Better Load Capacity
- ✓ Resistant to Weather
- ✓ Cost Effective Over Time
- ✓ Smoother, Safer Ride

TYPES OF PAVEMENT



FLEXIBLE PAVEMENT

RIGID PAVEMENT
(CONCRETE PAVEMENT)

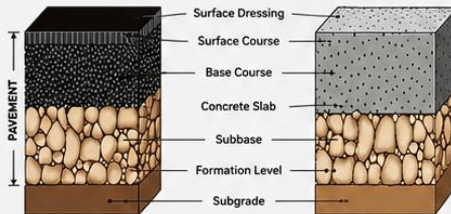

MODERN CONCRETE ROAD CONSTRUCTION



CONCRETE ROAD CONSTRUCTION PROCESS

- 1 SITE PREPARATION**
Clearing, grading, and excavation to required formation level.
- 2 SUBBASE PREPARATION**
Compaction of subgrade and placement of subbase materials.
- 3 FORMWORK & REINFORCEMENT**
Setting forms and installing BFRP rebar for maximum strength and durability.
- 4 CONCRETE PLACEMENT**
Placing and spreading high-quality concrete using modern equipment.
- 5 FINISHING & CURING**
Screeding, floating, texturing, and curing for long-term performance.
- 6 JOINT CUTTING & SEALING**
Cutting control joints and sealing to prevent cracking and extend road life.

CLOSING / CONSTRUCTION EQUIPMENT

EXCAVATOR  Digging and material handling.	LOADER  Loading and stockpiling materials.	MOTOR GRADER  Grading and leveling subgrade.	VIBRATORY ROLLER  Compaction of subbase and base.	CONCRETE MIXER TRUCK  Transporting fresh concrete.	CONCRETE PAVER / SPREADER  Placing and spreading concrete.
CONCRETE FINISHER  Surface finishing and smoothing.	CURING SPRAYER  Applying curing compound for moisture retention.	SAW CUTTER  Cutting control joints in concrete.	DUMP TRUCK  Hauling materials to and from site.	WATER TANKER  Water for compaction and curing.	LIGHT TOWER  Night work illumination.

BASALT FIBER REINFORCED POLYMER (BFRP) REBAR

Made from natural basalt rock



KEY ADVANTAGES

- RUST-FREE**
Completely immune to chlorides, saltwater, and alkaline environments, stopping the rust-spalling cycle before it starts.
- SUPERIOR STRENGTH**
Exhibits up to $\geq 200\%$ the tensile strength of steel while being roughly 4.5 times lighter.
- NON-CONDUCTIVE**
Does not interfere with electromagnetic fields or electrical currents, making it ideal for hospitals and data centers.
- ECO-FRIENDLY**
Features a much lower carbon footprint during production compared to steel.

WHY BFRP REBAR IN CONCRETE ROADS?

- ✓ Longer lifespan in harsh environments.
- ✓ Reduced maintenance and repair costs.
- ✓ Better crack control and structural performance.
- ✓ Ideal for bridges, culverts, coastal roads, and high-traffic highways.



BFRP REBAR INSTALLATION STRONGER. LIGHTER. SMARTER.

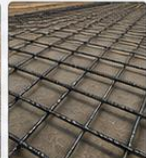

BUILT TO LAST